

Les détails des formes non cotées sont à la discrétion du fabricant.  
 Details of form, not stated, are at the manufacturer's option.

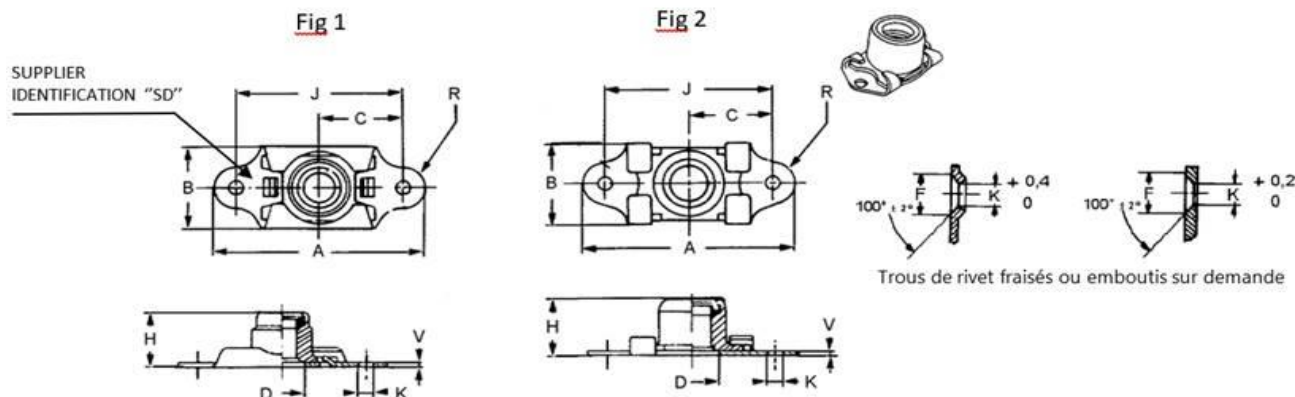

SIMMONDS PART NUMBER	THREAD	Fig	A Min.	B		C ± .005	D		F ± .010	H		J ± .002	K + .005 + .000	R	V Max.
				Max.	Min.		Max.	Min.		Max.	Min.				
<b>SNLA039-04</b>	.1120-40 UNJC-3B	1	.984	.416	.328	.344	.260	.198	.200	.218	.140	.688	.098	.148 .115	.075
<b>SNLA039-06</b>	.1380-32 UNJC-3B	1	.984	.416	.328	.344	.260	.198	.200	.234	.160	.688	.098	.148 .115	.075
<b>SNLA039-08</b>	.1640-32 UNJC-3B	1	.984	.416	.328	.344	.270	.224	.200	.312	.234	.688	.098	.148 .115	.075
<b>SNLA039-3</b>	.1900-32 UNJF-3B	2	.984	.416	.328	.344	.270	.250	.200	.312	.234	.688	.098	.148 .115	.075
<b>SNLA039-4</b>	.2500-28 UNJF-3B	2	1.296	.516	.406	.500	.330	.310	.200	.387	.283	1.000	.098	.148 .115	.075
<b>SNLA039-5</b>	.3125-24 UNJF-3B	2	1.296	.609	.484	.500	.393	.373	.230	.387	.283	1.000	.130	.148 .115	.075
<b>SNLA039-6</b>	.3750-24 UNJF-3B	2	1.296	.641	.583	.500	.455	.435	.230	.479	.439	1.000	.130	.148 .115	.075
<b>SNLA039-7</b>	.4375-20 UNJF-3B	2	1.477	.719	.672	.562	.517	.497	*	.504	.470	1.125	.130	.176 .146	.115
<b>SNLA039-7Q</b>	.4375-20 UNJF-3B	2	1.477	.719	.672	.562	.517	.497	*	.504	.470	1.125	.161	.176 .146	.115
<b>SNLA039-8</b>	.5000-20 UNJF-3B	2	1.602	.859	.796	.625	.580	.560	*	.630	.596	1.250	.130	.176 .146	.115
<b>SNLA039-8Q</b>	.5000-20 UNJF-3B	2	1.602	.859	.796	.625	.580	.560	*	.630	.596	1.250	.161	.176 .146	.115

Contact Arconic for the diameter/type in manufacturing

■ Dimensions in Inches.

<b>MATERIAL:</b>	Nut: Aluminum alloy.	Housing : Alloy steel.
<b>FINISH:</b>	Nut: Anodized, blue color. Cetyl alcohol.	Housing : Cadmium plate.
<b>LOCKING INSERT:</b>	Gold color nylon (250° F max. performance).	
<b>THREADS:</b>	In accordance with AS8879 before lubrication.	
<b>PERFORMANCE:</b>	NASM25027 applicable.	
<b>MARKING:</b>	"SD" on the area indicated on the drawing.	
<b>FLOATABILITY:</b>	Float of the nut portion of assembly shall not be less than .030 laterally and longitudinally from the centered position. Nut body shall be capable of engagement with a bolt in the maximum misaligned position. Maximum vertical float within the housing .020 for .1900 size and smaller .030 for .2500 size and larger.	
<b>OPTION:</b>	Dimpled or countersunk rivet holes as indicated on the drawing. Add code K after the reference (ex: SNLA039-3K) *(see on table): No countersunk or dimpled rivet type available for sizes .4375 and .5000.	
<b>APPLICATION:</b>	Type SNLA parts are designed for use with oversize clearance holes to permit interchangeable mounting of parts and sub-assemblies with a lesser degree of alignment accuracy than is usually required with fixed nuts.	
<b>NOTES:</b>	For oversize rivet holes, (.161 DIA. for sizes -7 and -8 per NAS1031) add code Q after the reference (ex: SNLA039-7Q). This variation is subject to a minimum order quantity if not available from stock. The P/N SNLA039-7 and SNLA039-8 do not conform to NAS1031.	